

(SBU) - Blue Earth Municipal Airport		5-YEAR AIRPORT CAPITAL IMPROVEMENT PLAN (ACIP) 2016-2020							Federal Entitlement Balance FY 2015:			Federal Entitlement Balance						
State FY	Fed FY	Description	FAA %	State %	Local %	Project Cost	Federal Entitlement Funding	Other Federal Funding	State Funding	Local Funding	Other Programs	Federal Entitlement Balance						
		Entitlement Transfer from Hawley, pay back in 2016 FFY										\$150,000						
		Entitlement Transfer from Austin, pay back by 2020 FFY										\$114,623						
2016	2015	Rehabilitate Hangar Area Pavement (FAA Eligible)	90%	5%	5%	\$ 453,982	\$ 408,584	\$ -	\$ 22,699	\$ 22,699	\$ -	\$71,309						
2016	2015	Rehabilitate Hangar Area Pavement (FAA Ineligible)	0%	80%	20%	\$ 489,839	\$ -	\$ -	\$ 391,871	\$ 97,968	\$ -	\$71,309						
											FY 2016	\$221,309						
2016	Pay back Hawley											-\$150,000						
2017	2016	No Projects Planned										\$ -	\$ -	\$ -	\$ -	\$71,309		
											2016 Project Totals:	\$ -	\$ -	\$ -	\$ -	\$ -	FY 2017	\$221,309
2018	2017	Construct Arrival/Departure Building Expansion	90%	0%	10%	\$ 140,000	\$ 126,000	\$ -	\$ -	\$ 14,000	\$ -	\$95,309						
											2017 Project Totals:	\$ 126,000	\$ -	\$ -	\$ 14,000	\$ -	FY 2018	\$245,309
		Entitlement Transfer from AIRPORT, pay back by ?? FFY										\$200,000						
2019	2018	SRE Building	90%	0%	10%	\$ 372,000	\$ 334,800	\$ -	\$ -	\$ 37,200	\$ -	\$110,509						
											2018 Project Totals:	\$ 334,800	\$ -	\$ -	\$ 37,200	\$ -	FY 2019	\$260,509
2020	2019	South Taxilane and Access Road with Gate	90%	0%	10%	\$ 290,000	\$ 261,000	\$ -	\$ -	\$ 29,000	\$ -	-\$491						
											2019 Project Totals:	\$ 261,000	\$ -	\$ -	\$ 29,000	\$ -	FY 2020	\$149,509
2020	Pay back Austin											-\$114,623						
2021	2020	Operations Study and RPZ Report	0%	0%	100%	\$ 30,000	\$ -	\$ -	\$ -	\$ 30,000	\$ -	\$34,886						
											2020 Project Totals:	\$ -	\$ -	\$ -	\$ 30,000	\$ -	FY 2021	\$184,886
2022	2021	Update Env. Assessment Study for 4,600 feet	90%	0%	10%	\$ 110,000	\$ 99,000	\$ -	\$ -	\$ 11,000	\$ -	-\$64,114						
											2021 Project Totals:	\$ 99,000	\$ -	\$ -	\$ 11,000	\$ -	FY 2022	\$85,886
2023	2022	Acquire Land for 4,600' (Other-Than-Utility Standards)	90%	0%	10%	\$ 763,000	\$ 85,886	\$ 600,814	\$ -	\$ 76,300	\$ -	\$0						
											2022 Project Totals:	\$ 85,886	\$ 600,814	\$ -	\$ 76,300	\$ -	FY 2023	\$150,000
2024	2023	Construct Runway 16/34 Extension, Parallel Taxiway for 4,600 feet	90%	0%	10%	\$ 2,350,000	\$ 150,000	\$ 1,965,000	\$ -	\$ 235,000	\$ -	\$0						
											2023 Project Totals:	\$ 150,000	\$ 1,965,000	\$ -	\$ 235,000	\$ -	FY 2024	\$150,000
2025	2024	Heated Storage Hangar - Hangar Loan (20yr)	0%	80%	20%	\$ 1,110,000	\$ -	\$ -	\$ 888,000	\$ 222,000	\$ -	\$150,000						
											2024 Project Totals:	\$ -	\$ -	\$ 888,000	\$ 222,000	\$ -	FY 2025	\$300,000
Summary for Airport = Blue Earth Municipal Airport						TOTAL:	\$ 4,998,821	\$ 2,371,956	\$ 3,166,628	\$ 414,571	\$ 750,667	\$ -						

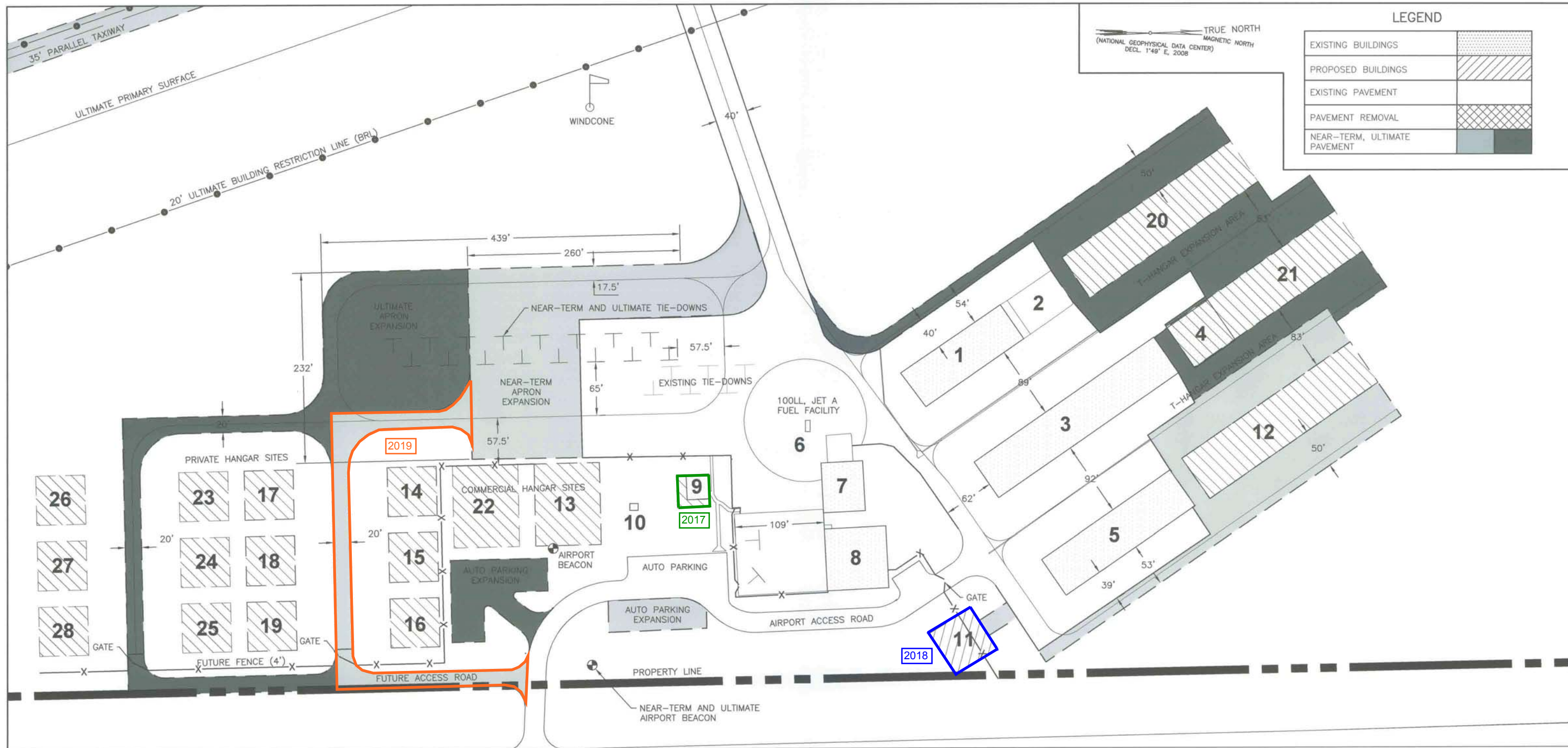

NO.	BUILDING TYPE	OWNER	TOP ELEV.	ULTIMATE DISPOSITION
20	10-UNIT T-HANGAR	CITY OF BLUE EARTH	-	TO BE CONSTRUCTED
21	8-UNIT T-HANGAR	CITY OF BLUE EARTH	-	TO BE CONSTRUCTED
22	COMMERCIAL HANGAR	-	-	TO BE CONSTRUCTED
23	PRIVATE HANGAR	-	-	TO BE CONSTRUCTED
24	PRIVATE HANGAR	-	-	TO BE CONSTRUCTED
25	PRIVATE HANGAR	-	-	TO BE CONSTRUCTED
26	PRIVATE HANGAR	-	-	TO BE CONSTRUCTED
27	PRIVATE HANGAR	-	-	TO BE CONSTRUCTED
28	PRIVATE HANGAR	-	-	TO BE CONSTRUCTED

NO.	BUILDING TYPE	OWNER	TOP ELEV.	ULTIMATE DISPOSITION
11	SRE STORAGE	CITY OF BLUE EARTH	-	TO BE CONSTRUCTED
12	10-UNIT T-HANGAR	CITY OF BLUE EARTH	-	TO BE CONSTRUCTED
13	COMMERCIAL HANGAR	-	-	TO BE CONSTRUCTED
14	PRIVATE HANGAR	-	-	TO BE CONSTRUCTED
15	PRIVATE HANGAR	-	-	TO BE CONSTRUCTED
16	PRIVATE HANGAR	-	-	TO BE CONSTRUCTED
17	PRIVATE HANGAR	-	-	TO BE CONSTRUCTED
18	PRIVATE HANGAR	-	-	TO BE CONSTRUCTED
19	PRIVATE HANGAR	-	-	TO BE CONSTRUCTED

NO.	BUILDING TYPE	OWNER	TOP ELEV.	ULTIMATE DISPOSITION
1	6-UNIT T-HANGAR	CITY OF BLUE EARTH	1125' EST.	TO REMAIN
2	SPRAY-WASH FACILITY	CITY OF BLUE EARTH	-	TO REMAIN
3	12-UNIT T-HANGAR	CITY OF BLUE EARTH	1125' EST.	TO REMAIN
4	COLD STORAGE HANGAR	CITY OF BLUE EARTH	1135' EST.	ULTIMATE RELOCATED
5	8-UNIT T-HANGAR	CITY OF BLUE EARTH	1125' EST.	TO REMAIN
6	FUEL PUMPS	CITY OF BLUE EARTH	-	TO REMAIN
7	SHOP HANGAR	CITY OF BLUE EARTH	1137' EST.	TO REMAIN
8	FBO HANGAR	CITY OF BLUE EARTH	1137' EST.	TO REMAIN
9	A/D BUILDING	CITY OF BLUE EARTH	1127' EST.	TO REMAIN
10	ELECTRICAL BUILDING	CITY OF BLUE EARTH	-	TO REMAIN

NOTE: BUILDINGS 4, 7, AND 8 ARE LEASED BY BLUE EARTH AVIATION, INC.